

# 25.78 Gb/s Short-Wavelength SFP+ AOC

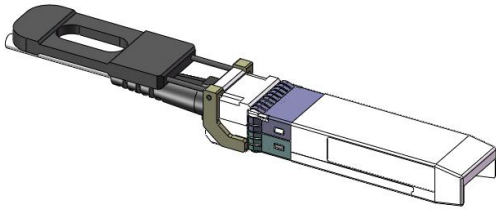

The RTX330-0XX short-wavelength AOC is designed for use in 25.78Gb/s data rate over multimode fiber . The AOC is compliant with SFF-8472, SFF-8402, SFF-8432 and applicable portions of SFF-8431. Digital diagnostics functions are available via a 2-wire serial interface, as specified in SFF-8472.

## Features

- Link lengths at 25.78G 100m over OM4 MMF
- Hot-pluggable
- Low power consumption <1.2W
- 0°C to 70°C operating temperature range
- Single +3.3V±5% power supply
- Digital Monitoring SFF-8472 compliant

## Applications

- 25G BASE-SR Ethernet

## Standards

- SFF-8472
- SFF-8402
- SFF-8432
- SFF-8431

## Specifications

(tested under recommended operating conditions, unless otherwise noted)

Parameter	Symbol	Unit	Min	Typ	Max	Note
Transmitter						
Nominal Wavelength	$\lambda$	nm	840		860	
Spectral Width	$\Delta\lambda$	nm			0.6	
Optical Modulation Amplitude	POMA	dBm	-6.4		3	
Optical Output Power	P <sub>av</sub>	dBm	-8.4		2.4	
Extinction Ratio	ER	dB	2			
Transmitter and Dispersion Penalty	TDP	dB			5	
Average launch power of OFF transmitter	P <sub>OFF</sub>	dBm			-30	
Receiver						
Center Wavelength	$\lambda$	nm	840		860	
Average Receiver Power	P <sub>AVG</sub>	dBm	-10.3		2.4	1
Stressed Receiver Sensitivity (OMA)	R <sub>SENSE</sub>	dBm			-5.2	2
Receiver Reflectance	R <sub>REFL</sub>	dB			-12	
Assert LOS	LOS <sub>A</sub>	dBm	-30			
De-Assert LOS	LOS <sub>D</sub>	dBm			-13	
LOS Hysteresis		dB	0.5			

**Note 1:** Sensitivity for 25.78G PRBS 2<sup>31</sup>-1 and BER better than or equal to 10E-6

**Note 2:** The stressed sensitivity value in the table are for system level BER measurements which include the effects of CDR circuit.

# 25.78 Gb/s Short-Wavelength SFP+ AOC

## Ordering Information

Part No.	Specifications									Application
	Package	Data rate(Gb/s)	Laser	Optical Power (dBm)	Detector	Stressed Sensitivity (OMA) dBm	Top	Reach (m)	Other	
RTXM330-0XX	SFP+	25.78	850nm VCSEL	-8.4 ~2.4	PIN	< -5.2	0~70 °C	0XX	DDM	25.78Gb/s single lane

## Absolute Maximum Ratings

Parameter	Symbol	Unit	Min	Max
Storage Temperature Range	Ts	°C	-40	85
Relative Humidity	RH	%	0	95
Supply Voltage	V <sub>CC</sub>	V	-0.3	4.0

## Recommended Operating Conditions

Parameter	Symbol	Unit	Min	Typ	Max
Operating Case Temperature Range	Tc	°C	0		70
Power Supply Voltage	V <sub>CC</sub>	V	3.14	3.3	3.46
Bit Rate	BR	Gb/s		25.78	
Bit Error Ratio	BER				10 <sup>-6</sup>
Max Supported Link Length	L	m			100